

Space used: 2000 m²

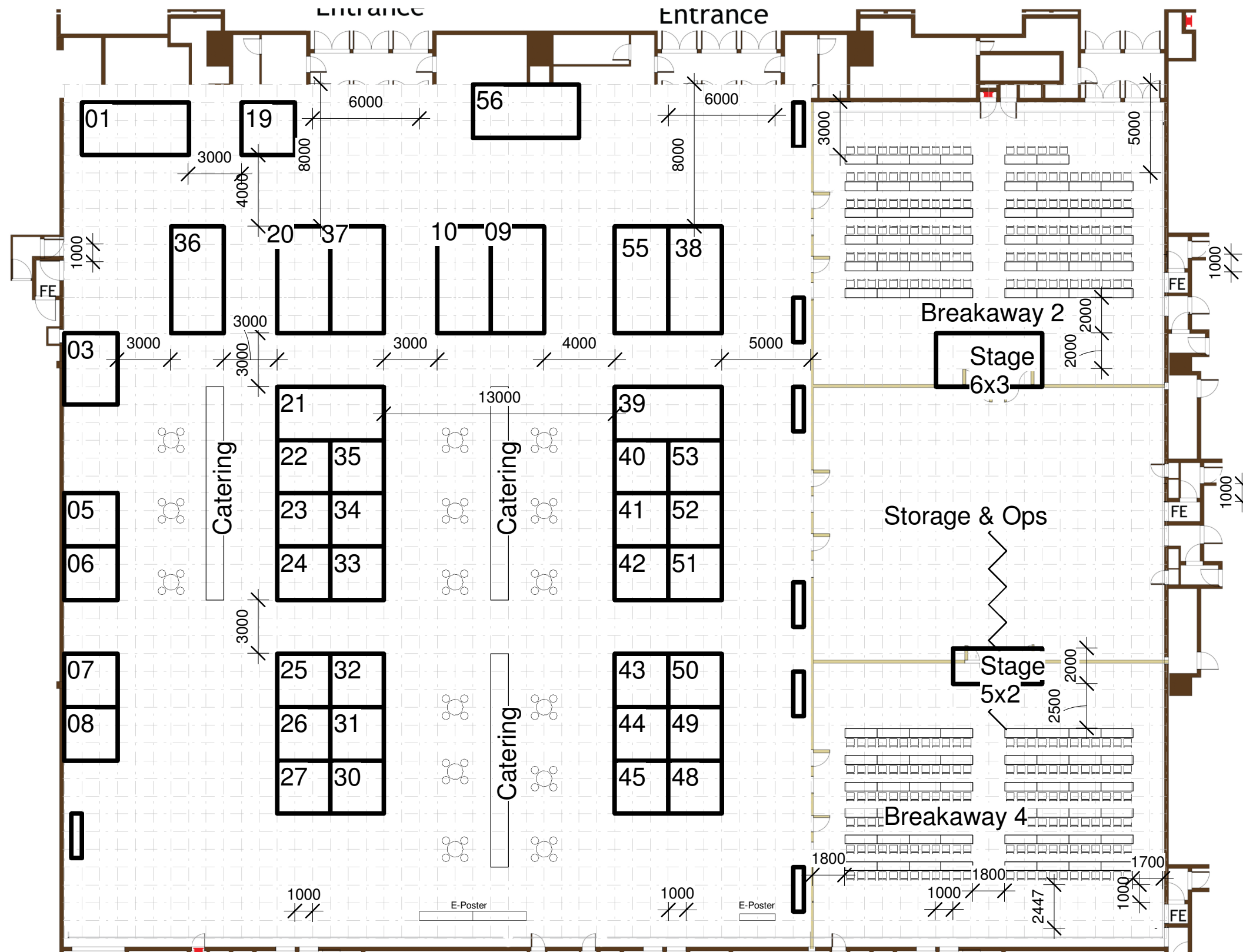

GENERAL NOTES

1. COPYRIGHT.
 - 1.1 Copyright exists in terms of the Copyright Act, Act No. 98 of 1978.
 - 1.2 Copyright in these drawings and in the designs which they depict. Any unauthorised copying of the drawings or use of the design constitutes infringement of copyright and is a criminal offence.
 - 1.3 In the event of criminal prosecution, the owner is entitled to sue for damages and claim delivery of the infringing copies.
 - 1.4 Copyright infringement includes the sale or distribution of the copy and "COPY" includes the adaptation thereof.
2. LAWS AND REGULATIONS.
 - 2.1 All works and building materials are to comply with National Building Regulations (SABS2040) and Building Standards Act No. 103 of 1977, as amended.
 - 2.2 Work to be carried out in strict accordance with by-laws and regulations of the relevant local authority.
 - 2.3 Light and ventilation are to comply with part (f) of NRBS.
3. DRAWINGS.
 - 3.1 Shop drawings must be approved by the client PRIOR to the manufacture of any shopfitting or items.
 - 3.2 Detail drawings must be preferred to arrangement drawings.
 - 3.3 One set of drawings are to be kept on site at all times.
 - 3.4 All revised drawings are to be clearly marked "REVISION #", and a copy of the revised drawing is to be handed to the contractor.
4. DIMENSIONS.
 - 4.1 Contractors and subcontractors are to check and verify dimensions and detail levels before commencing with any work.
 - 4.2 Figured dimensions are to be taken in preference to scaled dimensions.
5. VARIATIONS, REVISIONS AND AMENDMENTS.
 - 5.1 The designer is to be notified of any variation by the Project Manager.
 - 5.2 All relevant detail, levels and dimensions of any work done, must be checked on site by all contractors. Any discrepancies are to be reported to "Crazy Angel Designs" immediately.
6. CONTRACTORS AND SUBCONTRACTORS.
 - 6.1 Contractors must ensure the structural stability of all components of their work and ascertain that the main structure is capable of supporting all loads applied thereto.
 - 6.2 All electrical and drainage work is to be executed by registered artisans, and the relevant Certificates of Compliance to be issued to the client upon completion.
7. SHOPFITTED ITEMS.
 - 7.1 Shopfitted items are to be measured on site and shop drawings are to be approved by the designer AND client PRIOR to material order and manufacture.
8. PARTITIONS.
 - 8.1 All partitions on outside walls are set out from centre lines of columns or window mullions. Any dimensional errors should be accommodated within these parameters.
 - 8.2 All partitions to be rodent proofed and have a minimum of 30 minute fire rating.
 - 8.3 All partitions to comply to SANS082.



011 1000 287
 email: info@twowaysa.co.za
 www.twowaysa.co.za

No.	Description	Date
9	Revision 9	01/07/22
11	Revised details	18/07/22
12	Revised layout	20/07/22
13	Detail in Breakaway rooms	27/07/22
14	Revised fire safety	28/7/22
15	Revised layout	22/09/22
16	Revised layout	10/10/22

DATE DRAWN: 18/05/2022	DRAWN BY MS
PROJECT No. SAHC	SCALE 1 : 250 on A3

CURRENT DRAWING TITLE:
 SA Heart Congress
 28 - 30 October 2022
 (Setup on 27 October 2022)
 Hall Plan - SCC Ballroom 1.50

DWG No. SAHC-22-01

1 Hall Plan
 1 : 250

Space used: 500 m²

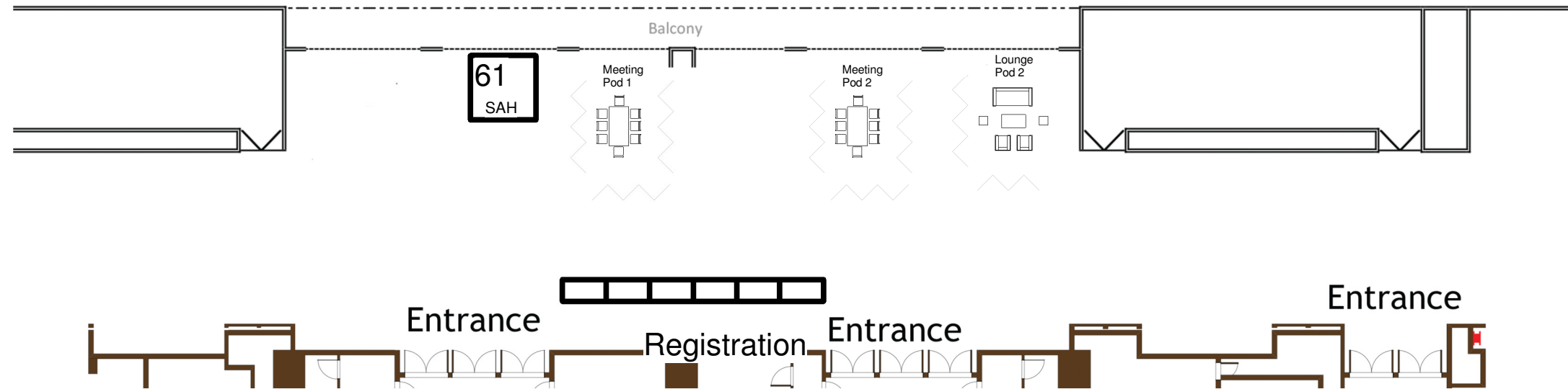

1 Foyer Plan
1 : 250

GENERAL NOTES

1. **COPYRIGHT.**
 - 1.1 Copyright exists in terms of the Copyright Act, Act No. 98 of 1978.
 - 1.2 Copyright in these drawings and in the designs which they depict. Any unauthorised copying of the drawings or use of the design constitutes infringement of copyright and is a criminal offence.
 - 1.3 In the event of criminal prosecution, the owner is entitled to sue for damages and claim delivery of the infringing copies.
 - 1.4 Copyright infringement includes the sale or distribution of the copy and "COPY" includes the adaptation thereof.
2. **LAWS AND REGULATIONS.**
 - 2.1 All works and building materials are to comply with National Building Regulations (SABS20400) and Building Standards Act No. 103 of 1977, as amended.
 - 2.2 Work to be carried out in strict accordance with by-laws and regulations of the relevant local authority.
 - 2.3 Light and ventilation are to comply with part (f) of NRBS.
3. **DRAWINGS.**
 - 3.1 Shop drawings must be approved by the client PRIOR to the manufacture of any shopfitting or items.
 - 3.2 Detail drawings must be preferred to arrangement drawings.
 - 3.3 One set of drawings are to be kept on site at all times.
 - 3.4 All revised drawings are to be clearly marked "REVISION #", and a copy of the revised drawing is to be handed to the contractor.
4. **DIMENSIONS.**
 - 4.1 Contractors and subcontractors are to check and verify dimensions and detail levels before commencing with any work.
 - 4.2 Figured dimensions are to be taken in preference to scaled dimensions.
5. **VARIATIONS, REVISIONS AND AMENDMENTS.**
 - 5.1 The designer is to be notified of any variation by the Project Manager.
 - 5.2 All relevant detail, levels and dimensions of any work done, must be checked on site by all contractors. Any discrepancies are to be reported to "Crazy Angel Design" immediately.
6. **CONTRACTORS AND SUBCONTRACTORS.**
 - 6.1 Contractors must ensure the structural stability of all components of their work and ascertain that the main structure is capable of supporting all loads applied thereto.
 - 6.2 All electrical and drainage work is to be executed by registered artisans, and the relevant Certificates of Compliance to be issued to the client upon completion.
7. **SHOPFITTED ITEMS.**
 - 7.1 Shopfitted items are to be measured on site and shop drawings are to be approved by the designer AND client PRIOR to material order and manufacture.
8. **PARTITIONS.**
 - 8.1 All partitions on outside walls are set out from centre lines of columns or window mullions. Any dimensional errors should be accommodated within these parameters.
 - 8.2 All partitions to be rodent proof and have a minimum of 30 minute fire rating.
 - 8.3 All partitions to comply to SANS082.



011 1000 287
email: info@twowaysa.co.za
www.twowaysa.co.za

No.	Description	Date
8	Revised layout	29/06/22
9	Revision 9	01/07/22
11	Revised details	18/07/22
13	Detail in Breakaway rooms	27/07/22
14	Revised fire safety	28/7/22
15	Revised layout	22/09/22
16	Revised layout	10/10/22

DATE DRAWN: 18/05/2022	DRAWN BY Designer
PROJECT No. SAHC	SCALE 1 : 250 on A3

CURRENT DRAWING TITLE:
SA Heart Congress
28 - 30 October 2022
(Setup on 27 October 2022)
Foyer Plan - SCC Ballroom 1.50

DWG No. SAHC-22-02